

Take a look at the
village website for news
& information

www.kelsall-pc.org.uk

Kelsall Parish Council Newsletter

March 2025

Kelfest – taking a year off

Our new village event, KElfEST, was run in summer 2023 and 24, and it's fair to say it was welcomed by residents.

It also proved quite a lot of work, and the original team would need new blood to organize it again. Sadly, not enough volunteers came forward following online appeals, and therefore the event will not run in 2025.

We hope to bring it back next year. Let us know if you'd like to join the organising Committee



Speed management

Kelsall Parish Council (KPC) keep working to address residents' concerns about local speeding,

In 2022 we set up a Community Speedwatch group, but when the speeding data was sent to the Police, they only sent advice letters to speeding drivers. So we decided to buy our own Speed Indicating Device, SID.

You will have seen monitoring a number of locations, including Chester Road, Church St, Flat Lane and Quarry Lane. It automatically records the speeds of passing vehicles 24/7 and the statistical information recorded is passed to the Police. They then decide which locations they should monitor to identify & prosecute speeding motorists.

It consistently finds that most speeding occur between 3 - 4pm, ie. school pick up time, and 5.45 - 6.35pm when people return from work. It is concerning that the worst speeding is around the time that children are out and about.



A new Green Space for Kelsall?

In June CWAC turned down our request to transfer a neglected area of land on the edge of the village, which they owned. Our intention was to create a new community green space, while working together on the site to improve the land for wildlife and environment.

Unfortunately, after 12 months of planning, research, and meetings, CWaC said they could not allow us to do this, stating that their strategic priorities are to support Climate change and Wildlife and Ecology. Even though our proposals for this site were low key, CWAC decided that they would all have an adverse effect on the established site ecology

This was disappointing for our aspirations to establish a new 'quiet' green facility for the community.



We will now try to pursue our goals to improve green spaces in Kelsall in other areas. The village does need more open space -Since KPC acquired Kelsall Green, Kelsall has gained several hundred residents, and in the medium term, more housing development is bound to come our way. The Green is already a well-used space and offers limited scope for more environmental or community uses



Kelspaces - Introducing Kelspaces, our local community gardening group:

This group of gardening and wildlife enthusiasts came together to make Kelsall's many small green spaces more attractive for residents and more beneficial to the environment.

Supported by KPC, the group plans to improve unused grass areas, for biodiversity with small trees or planting for pollinators, or simply to make them more attractive, with community planting or seating.

It has started by improving small green corner of Church St North and Chester Road. where low maintenance herbs and evergreens have been planted

See our page on the village website, under Parish Council/Green Spaces

Please let us know if you have suggestions for our shared green spaces, or would like to get involved in the project.

Reviewing our Neighbourhood Plan: Making planning changes work for us

Our Neighbourhood Plan has now been in force for 7 years, and enabled the development of the new GP Surgery and Wellbeing Hub, along with the adjacent housing for over 55s. It has also helped control development at the edges of the village.

Changes to Planning policies, and increased housing development targets, are coming down the line and we need to ensure that our Neighbourhood Plan is updated, to maximise the potential benefits to our area and minimise the impact of future development.

We are in the very early stages of this review, and will be working to understand coming planning changes and other drivers. These drivers include increased national targets for housebuilding targets, new legislation related to climate change and to protect biodiversity, as well as review to the Green Belt.

We also need to see what resources and help are available to support us.

If you would like to help in this effort, please get in touch. The Parish Council will not be able to deliver valuable results without more participation from residents.

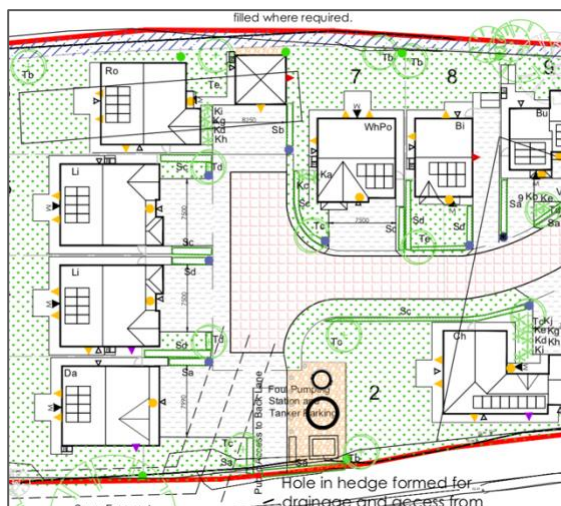

Kelsall Green update

KPC owns and maintains Kelsall Green and the playground. We have replaced some of the play equipment in recent years. As the rest of the playground ages, we need to find resources in our budget to fund repairs and further replacements.

We also keep improving the Green generally, with new benches and picnic tables. We have chosen recycled plastic tables and benches to ensure that they last better. Similarly, we try to select all new equipment with longevity in mind, to make the best of our resources. In the past, the wooden playground kit was bought with help from contributions developers must pay to the community – but these are not a source of income we want to rely on.

Could you take an active part in the community?

Parish Councillors are residents who volunteer to work on public matters in Kelsall. Many volunteers in other societies also contribute to making our village a great place to live. Can you also step up and be active in your community?

Organising Kelfest

The team that successfully organised Kelfest in July 23 and 24 is looking for new blood to bring the event back in 2026!

Updating our Neighbourhood Plan

Please let us know if you want to help us create the next plan make development work for our village.

Look out for our requests for feedback in the coming months.

www.kelsall.org.uk

The village website is available for your news and listings, in a format more durable than a Facebook post.

If you run a group or business, or you're organising an event, send any information you'd like to share to webmaster@kelsall.org.uk

Dealing with Highways issues

Please use the Cheshire West 'Report It' facility to flag blocked drains, potholes and other road defects.

They have reduced maintenance of roads and drains, and what they do is largely driven by reports from the public.

Contact clerk@kelsall-pc.org.uk regarding any of these



Kelspaces

We are looking for some enthusiastic residents who could work with us to look after smaller green spaces in Kelsall. Can you contribute time and ideas, to maintain the planting, , look into or even suggest options for improving the spaces?

Parish Council Vacancies

KPC has space for two councillors. Can you help us look after Kelsall? Take a look at our website to get a better idea of what we do, come to a meeting,

Remember, you can come to our monthly meetings, at 7pm on the 2nd Monday of the month at the St Philips Church Lounge



Follow us on Facebook to stay informed